

☆ *Snap-Tite*

ISO-9001  
Certified

Hydraulic  
Couplings

**76**  
SERIES



# **76 Series — Hydraulic Couplings**

*Featuring...Snap-tite quality with higher working pressure and better flow performance than the competition.*



- High strength soft seat poppet valves insure zero leakage and higher flow rates than commonly used metal-to-metal sealing ball design.
  - Heavy duty steel construction with yellow zinc dichromate plating for excellent corrosion resistance.
  - Working pressures up to 14,500 psi (1,000 bar).
  - Available in 1/4" and 3/8" sizes.
- 
- The specially designed threaded sleeve has knurling at the front to facilitate connection by hand. The hex at the back allows connection with the use of a wrench.
  - This coupling will interconnect with the Parker 3000 Series, Faster PVV Series, Perfecting 300 Series, Powerteam C38, Enerpac C-604, and other screw-to-connect couplings used in the hydraulic tool and rescue equipment markets.
  - The couplers are available with male NPT, female NPSF, or female British parallel BS2779 end fittings. The nipples are available with female NPSF or female British parallel BS2779 end fittings. Other end fittings are available -- consult factory.

PERFORMANCE		
	1/4"	3/8"
Maximum Working Pressure (bar)	14,500 psi (1000)	14,500 psi (1000)
Minimum Burst Pressure (bar)	29,000 psi (2000)	29,000 psi (2000)
Torque to connect at 500 psi (35 bar)	20 in. lb. (0.23 kg.m.)	60 in. lb. (0.7 kg.m.)
Spillage upon disconnect at 15 psi (1 bar)	0.80 cc	0.95 cc

## TECHNICAL AND DIMENSIONAL INFORMATION

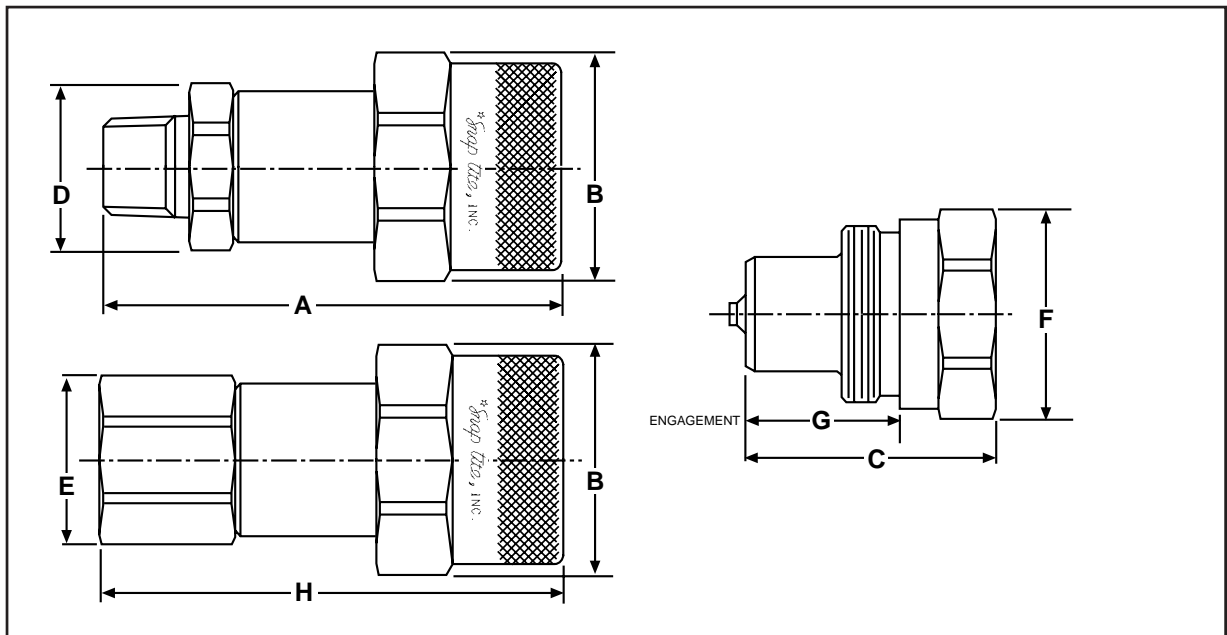

SIZE	A		B (Hex)		C		D		E (Hex)		F (Hex)		G Engagement		H	
	in	mm	in	mm	in	mm	in	mm	in	mm	in	mm	in	mm	in	mm
1/4	2.60	66.04	1.250	31.70	1.39	35.30	0.96	24.30	0.875	22.20	1.00	25.40	0.72	18.20	2.55	64.70
3/8	2.97	75.40	1.375	34.90	1.62	41.40	1.10	27.90	1.00	25.40	1.25	31.80	0.99	25.10	3.01	76.50

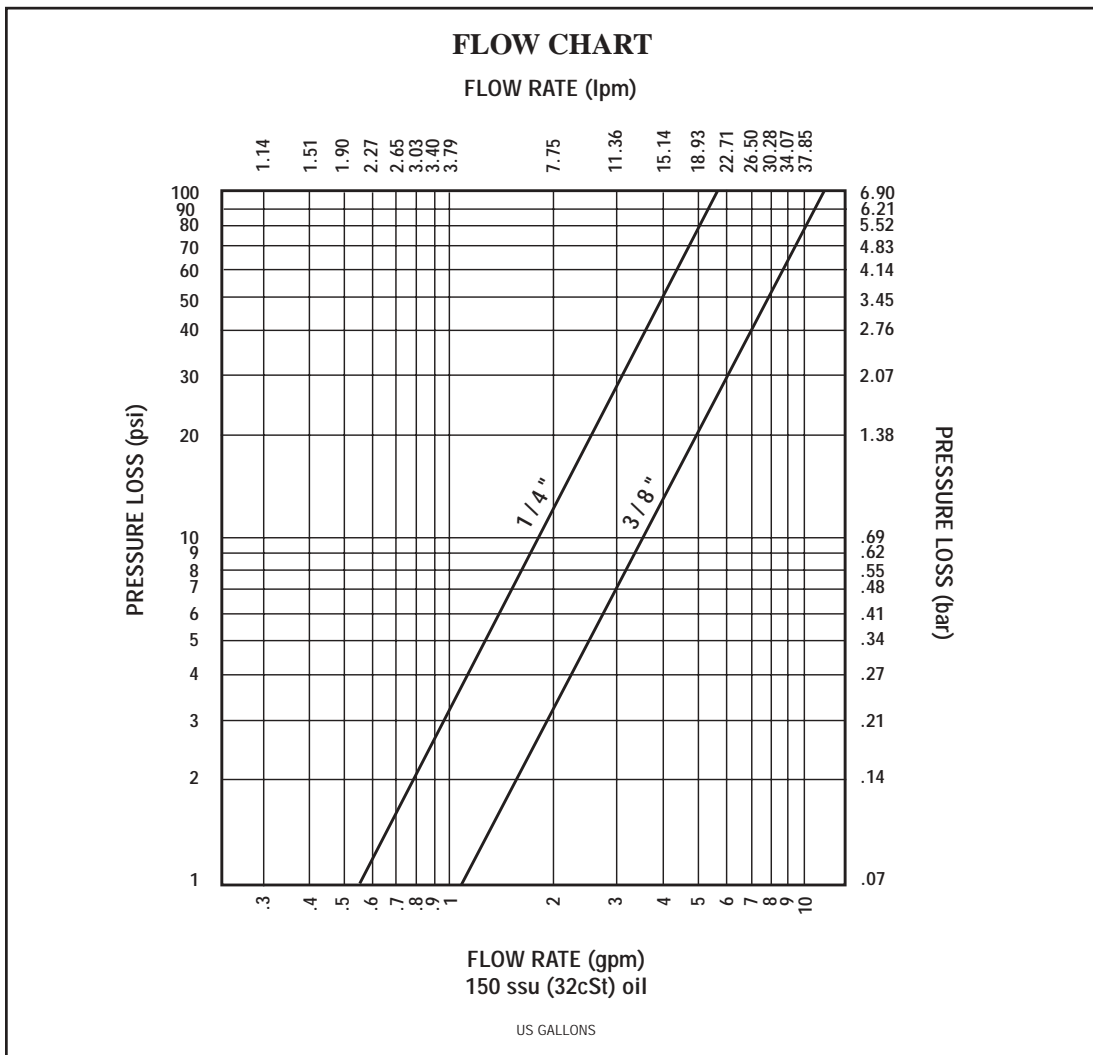

## HOW TO ORDER

Part No.	76	C	6-	6	F
----------	----	---	----	---	---

Series	Coupling Half	Coupling Size	End Fitting Size	End Fitting Type
76	C Coupler N Nipple	4 = 1/4" 6 = 3/8"	4 = 1/4" 6 = 3/8"	F Female NPSF RP Female British Parallel BS2779 M* Male NPT *Available on coupler only

Standard seal is Buna N (Code A). For other seal materials, consult factory.

## ACCESSORIES \*

	DUST PLUG	DUST CAP
1/4"	76MDP-4	76MDC-4
3/8"	76MDP-6	76MDC-6

\* Dust caps and dust plugs are manufactured from plated carbon steel.

## ! WARNING !

FAILURE OR IMPROPER SELECTION OR IMPROPER USE OF THE PRODUCTS AND/OR SYSTEMS DESCRIBED HEREIN OR RELATED ITEMS CAN CAUSE DEATH, PERSONAL INJURY AND PROPERTY DAMAGE.

*This document and other information from Snap-tite, Inc., its subsidiaries and authorized distributors provide product and/or system options for further investigation by users having technical expertise. It is important that you analyze all aspects of your application and review the information concerning the product or system in the current product catalog. Due to the variety of operation conditions and applications for these products or systems, the user, through its own analysis and testing, is solely responsible for making the final selection of the products and systems and assuring that all performance, safety and warning requirements of the application are met.*

*The products described herein, including without limitation, product features, specifications, designs, availability and pricing, are subject to change by Snap-tite, Inc. and its subsidiaries at any time without notice.*



**Quick Disconnect & Valve Division**  
 201 Titusville Road  
 Union City, Pennsylvania 16438-8699 USA  
 PH: 814-438-3821 FAX: 814-438-3069  
 e-mail: qd&v\_sales@snap-tite.com  
 www.snap-tite.com



Industrial Estate  
 Whitemill - Wexford  
 Republic of Ireland  
 PH: 353-53-41566 FAX: 353-53-41582  
 e-mail: ste\_sales@snap-tite.com  
 www.snap-tite.com

**DISTRIBUTED BY:**

## ISO-9001 Certified